

Aerial View looking North

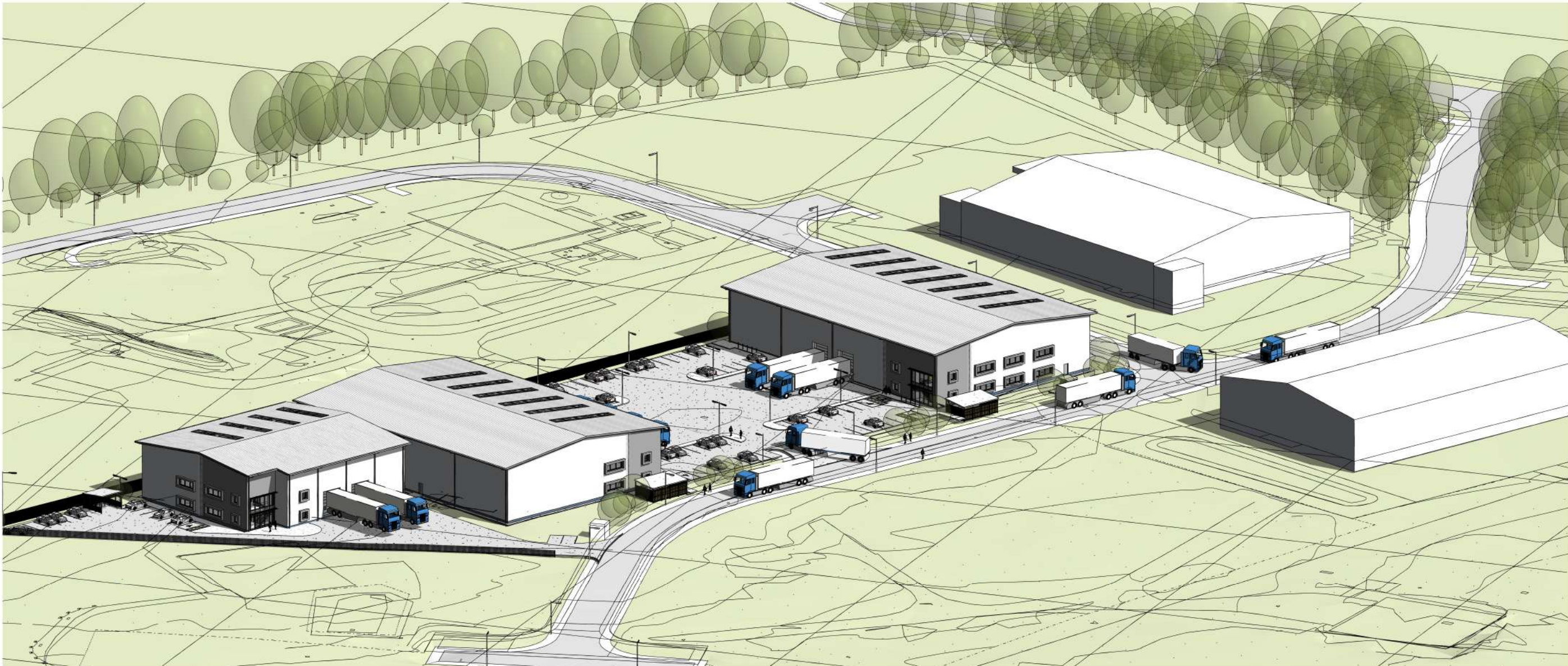

Aerial View looking East

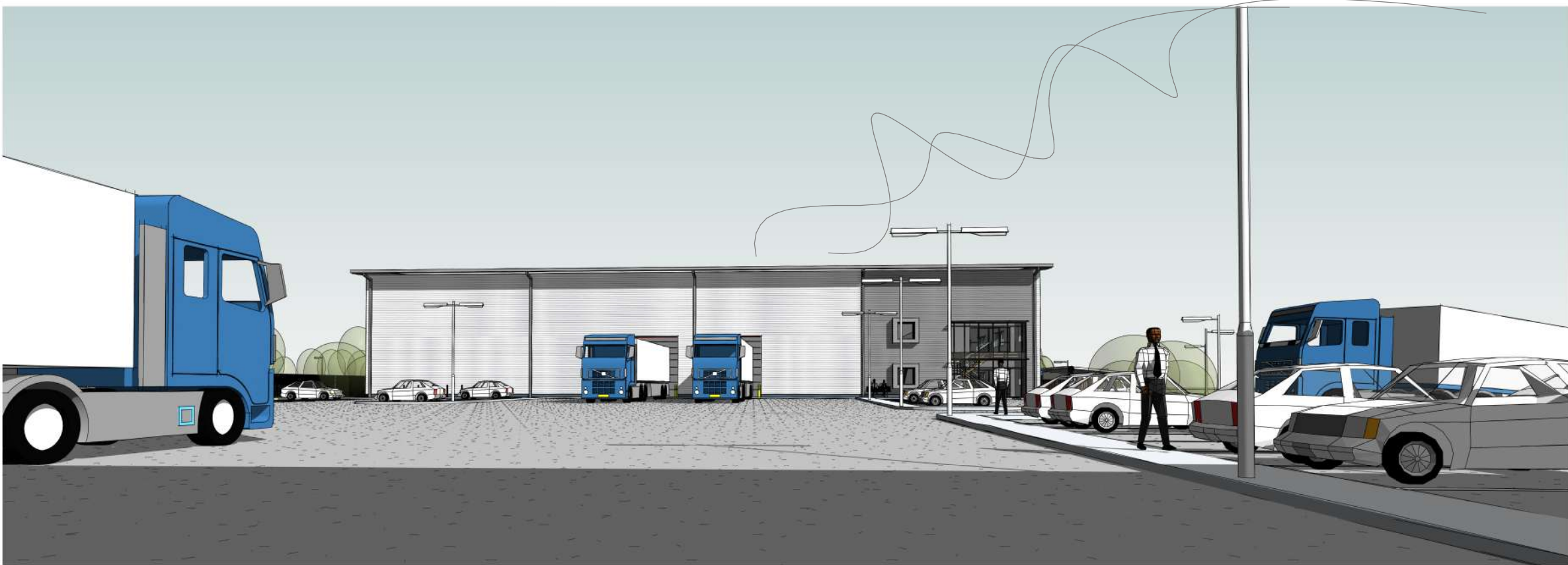

Perspective View across yard



View along Spitfire Way

Notes:
Lewis & Hickey accept no responsibility for any costs, losses, claims howsoever arising from these drawings, specifications and related documents unless there is full compliance with the client and any authorised user of the following:
1. All boundaries, dimensions and levels are to be checked on site before construction and any discrepancies are to be reported to the Architect / Designer.
2. Partial Service: Any discrepancies with site or other information is to be advised to the Architect / Designer and direction or approval is to be sought before the implementation of the detail.
3. Block and site plans are reproduced under license from the Ordnance Survey.
4. Do not scale this drawing.
5. For the purpose of coordination, all relevant parties must check this information prior to implementation and report any discrepancies to the Architect / Designer.

Revisions:		
Rev.	Date	Description
1	19/11/18	Amended as per comment re'vd 15/11/18.

APPENDIX A

PRELIMINARY

CLIENT

PROJECT
New Warehouse Development,
Faraday Business Park, Fareham

DRAWING
Plot 'F'. Proposed Perspective
Views

L
&
H

LEWIS
AND
HICKEY

18 Farnham Road
Guildford
Surrey
GU1 4XA

Tel: 01483 560908
Fax: 01483 560660
Email: gulford@lewishickey.com

SCALE	SIZE	DATE	DRAWN	CHECKED
	A1	Nov '18	JeC	

PROJECT No.	DRAWING No.	REVISION
G4473	P_205	1